

STREET 'F'

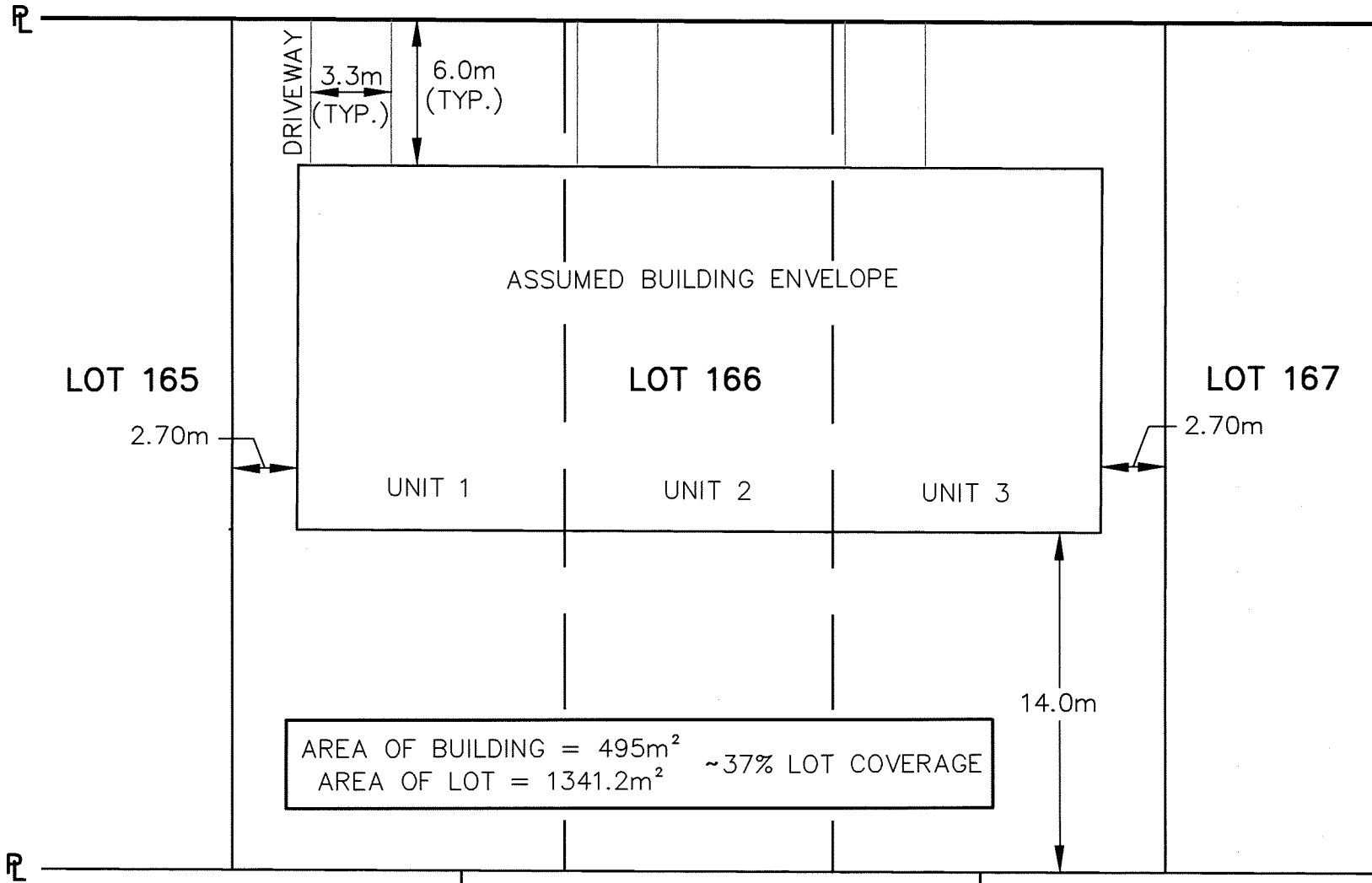

R.V. Anderson Associates Limited
 engineering • environment • infrastructure

LOT 166—STREET 'F'

HUNEALT SUBDIVISION

CHELMSFORD AREA

DRAWN BY: LZ

REV No:

DATE: 2021-12-20

REV DATE:

SCALE: NTS

CAD/FILE No.:

APP'D:

1
SHEET

DISCLAIMER OF WARRANTY : The data is provided "as-is", without warranty of any kind either expressed or implied. Any and all liabilities for damage, direct or indirect, however caused, and resulting in any way by use of the supplied data is the full and final responsibility of the user.

COPYRIGHT : All rights are reserved. No part of the supplied data may be reproduced, or transmitted to others, in any form or by any means, without the prior written permission of the R.V. ANDERSON ASSOCIATES LIMITED.

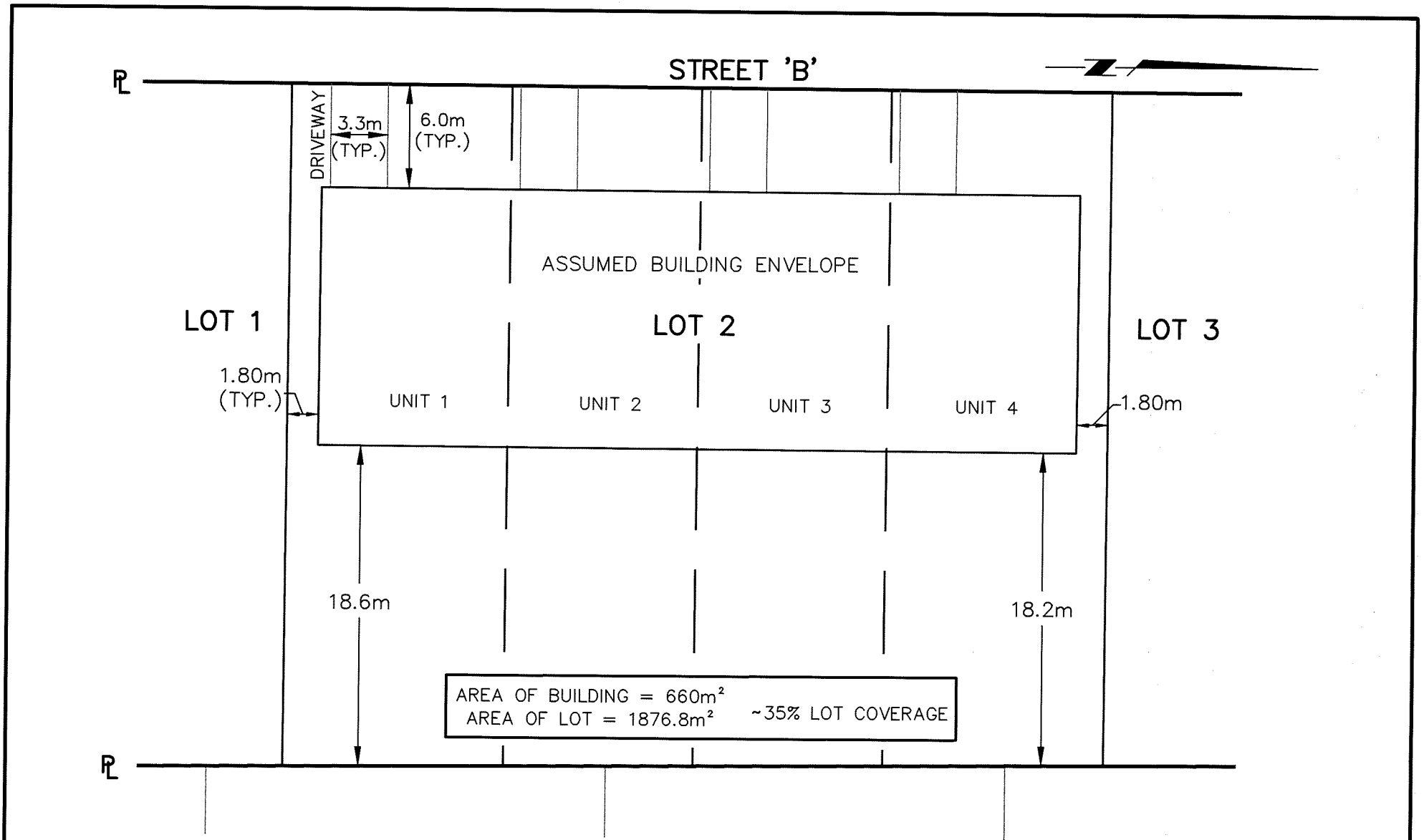

R.V. Anderson Associates Limited
 engineering • environment • infrastructure

LOT 2-STREET 'B'

HUNEALT SUBDIVISION
 CHELMSFORD AREA

DRAWN BY: LZ

REV No:

DATE: 2021-12-20

REV DATE:

SCALE: NTS

CAD/FILE No.:

APP'D:

1

SHEET

DISCLAIMER OF WARRANTY : The data is provided "as-is", without warranty of any kind either expressed or implied. Any and all liabilities for damage, direct or indirect, however caused, and resulting in any way by use of the supplied data is the full and final responsibility of the user.

COPYRIGHT : All rights are reserved. No part of the supplied data may be reproduced, or transmitted to others, in any form or by any means, without the prior written permission of the R.V. ANDERSON ASSOCIATES LIMITED.