

To be rezoned from P, Park to R1-2,
Low Density Residential One

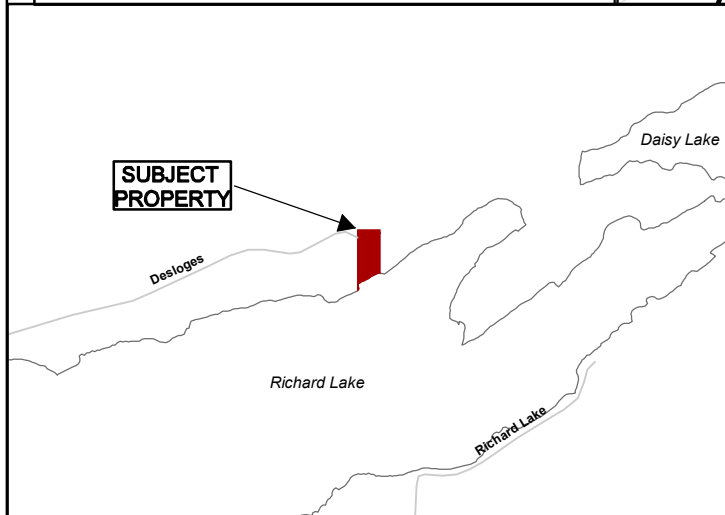

**Growth and Infrastructure
Department**



Subject Propert being,
PIN 73479-0181,
Parcel 15159 S.E.S, in
Concession 6, Lot 9,
Township of Dill,
2631 Desloges Road, Sudbury,
City of Greater Sudbury

Date: 2022 06 23