

PREPARED FOR
DALRON HOMES

PREPARED BY
J.L. Richards
 ENGINEERS-ARCHITECTS-PLANNERS

J.L. Richards & Associates Limited
 217-469 Bouchard Street
 Sudbury, ON Canada
 P3E 2K6
 Tel: 705 522 8174
 Fax: 705 522 1512

Del Bosco
 SURVEYING LTD.
 75 LORNE STREET SUDBURY, ONTARIO
 P3C 4P2 705-671-2295

IN COOPERATION WITH
 FILE 7926

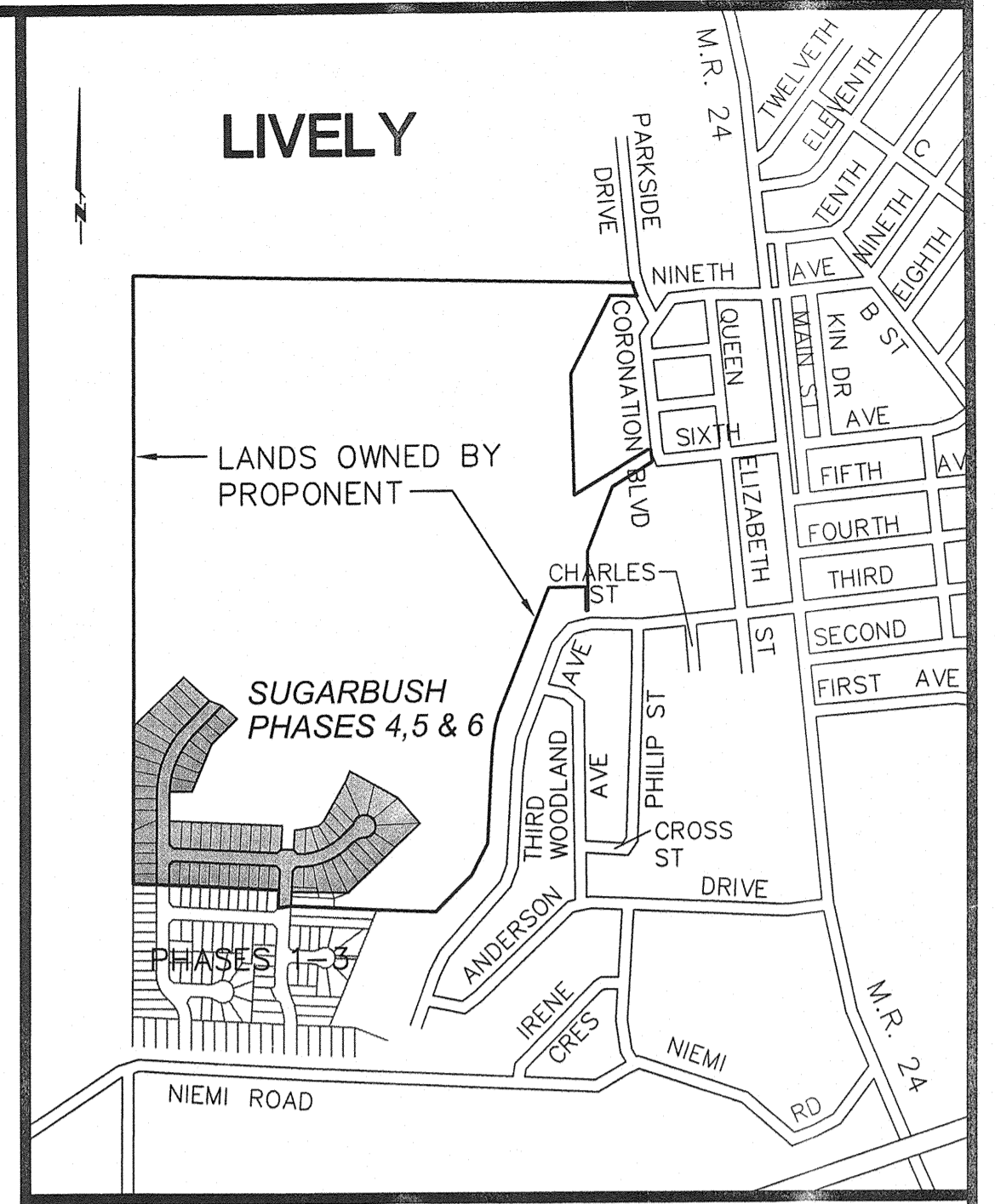

KEY PLAN SCALE - 1:10000

DRAFT PLAN OF SUBDIVISION

PART OF P.I.N. 73377-1463
 PART OF LOT 8, CONCESSION 5
 GEOGRAPHIC TOWNSHIP OF WATERS
 BEING PART OF THE
 CITY OF GREATER SUDBURY
 DISTRICT OF SUDBURY

- LEGEND**
- DENOTES SURVEY MONUMENT FOUND
 - DENOTES SURVEY MONUMENT SET
 - SIB DENOTES STANDARD IRON BAR
 - SSB DENOTES SHORT STANDARD IRON BAR
 - IB DENOTES IRON BAR
 - RB DENOTES ROCK BAR
 - RPL DENOTES ROCK PLUG
 - M DENOTES MEASURED
 - S DENOTES SET
 - NVM DENOTES NO VISIBLE MARKINGS
 - WT DENOTES WITNESS MONUMENT
 - PROP DENOTES PROPORTIONED
 - P.I.N. DENOTES PROPERTY IDENTIFICATION NUMBER
 - 707 DENOTES LANE & LANE, O.L.S.
 - 1400 DENOTES D. S. DORLAND, O.L.S.
 - 1655 DENOTES TERRY DEL BOSCO, O.L.S.
 - P DENOTES REGISTERED PLAN M-936
 - P2 DENOTES REGISTERED PLAN M-931
 - P3 DENOTES REGISTERED PLAN M-922
 - P4 DENOTES REGISTERED PLAN 53M-1332
 - P5 DENOTES PLAN 53R-12891
 - P6 DENOTES PLAN 53R-11061
 - P7 DENOTES REGISTERED PLAN 53M-1332
 - P8 DENOTES REGISTERED PLAN 53M-1369
 - P9 DENOTES PLAN 53R-11602
 - P10 DENOTES REGISTERED PLAN 53M-1160
 - P11 DENOTES PLAN 53R-17718
 - P12 DENOTES REGISTERED PLAN M-923
 - P13 DENOTES PLAN 53R-17930
 - P14 DENOTES PLAN 53R-4887
 - SR DENOTES SURVEY RECORDS OF LANE & LANE, O.L.S. REF. No. 43 (V-8-WATERS)
 - /- DENOTES NOT TO SCALE

OWNER
 DALRON CONSTRUCTION LIMITED
 130 ELM STREET
 SUDBURY, ONTARIO
 P3C 1T6

OWNER'S CERTIFICATE
 I HEREBY CONSENT TO THE MANNER IN WHICH THE LAND SHOWN ON THIS PLAN IS PROPOSED TO BE SUBDIVIDED AND REQUEST THE APPROVAL OF THE CITY OF GREATER SUDBURY.

Oct 28/08
 DATE

Ron Arnold
 RON ARNOLD - PRESIDENT
 DALRON CONSTRUCTION LTD.

ONTARIO LAND SURVEYOR
 TERRY DEL BOSCO O.L.S.
 75 LORNE STREET
 SUDBURY, ONTARIO
 P3C 4P2

SURVEYOR'S CERTIFICATE
 I CERTIFY THAT THE BOUNDARIES OF THE LANDS TO BE SUBDIVIDED AND THEIR RELATIONSHIP TO THE ADJACENT LANDS ARE ACCURATELY AND CORRECTLY SHOWN ON THIS PLAN.

Oct. 22, 2008
 DATE

Terry Del Bosco
 TERRY DEL BOSCO O.L.S.

Subject to the conditions, if any set forth in our letter dated *March 18th 2009* this draft plan is approved under section 51 of The Planning Act, R.S.O. 1990 this *18th day of March 2009*
D.E. Lantack
 By-Law 2006-259

OLS NOTE
 ALL BEARINGS SHOWN HEREON ARE GRID AND ARE REFERRED TO THE CENTRAL MERIDIAN THROUGH 81° WEST LONGITUDE OF THE UTM ZONE 17, AND ARE DERIVED FROM THE CITY OF GREATER SUDBURY COORDINATES FOR THE CONTROL MONUMENTS No.'s 027950009 D AND 027950010 A, HAVING COORDINATES AS FOLLOWS:

	NORTHING	EASTING
027950009 D	5142985.014	488642.519
027950010 A	5141599.466	488810.226

THESE ARE METRIC UTM ZONE COORDINATES BASED ON THE 1976 FREE ADJUSTMENT ON THE 1927 DATUM

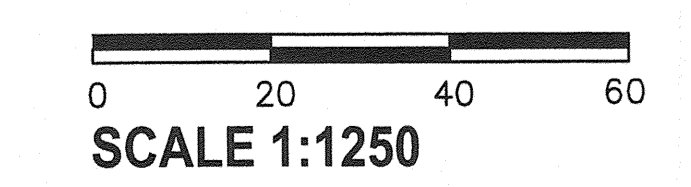

- ADDITIONAL INFORMATION**
 AS REQUIRED BY SECTION 51(17) OF THE PLANNING ACT
- A) AS SHOWN
 - B) AS SHOWN
 - C) AS SHOWN
 - D) 1-5 & 26-69 - R1 SINGLE RESIDENTIAL
 LOTS 6-25 - R2 DOUBLE RESIDENTIAL
 BLOCK 70 - TEMPORARY CUL-DE-SAC BLOCK
 - E) NORTH - LOW DENSITY & UNDEVELOPED RURAL LANDS
 SOUTH - EXISTING LOW DENSITY RESIDENTIAL LANDS (EXISTING SUGARBUSH SUBDIVISION - PHASES 1, 2 & 3)
 WEST - UNDEVELOPED RURAL LANDS
 EAST - FUTURE PARKLAND / LOW DENSITY RESIDENTIAL
 - F) AS SHOWN
 - G) AS SHOWN
 - H) EXISTING MUNICIPAL SUPPLY
 - I) CLAY SOILS WITH ROCK OUTCROPS - HEAVILY TREED
 - J) AS SHOWN
 - K) STORM & SANITARY SEWER, MUNICIPAL WATER, POLICE, FIRE, AMBULANCE ETC.
 - L) AS SHOWN
- AREA OF APPLICATION = 7.286± HECTARES

SUGARBUSH SUBDIVISION

PHASES 4, 5 & 6