

Request for Decision

Parking Restrictions - 1) Michael Street, Rayside Balfour 2) South Bay Road, Sudbury

Presented To: Operations Committee

Presented: Monday, Mar 17, 2014

Report Date: Wednesday, Mar 05, 2014

Type: Managers' Reports

Recommendation

THAT the City of Greater Sudbury prohibit parking on both sides of Michael Street, from Highway 144 to Monique Street;

AND THAT the City of Greater Sudbury prohibit parking on the north side of South Bay Road, from 300 metres east of Athletic Building Road to Arlington Boulevard;

AND THAT the City of Greater Sudbury prohibit parking on the south side of South Bay Road from 300 metres east of Athletic Building Road to 350 metres east of Athletic Building Road;

AND THAT a by-law be passed by City Council to amend Traffic and Parking By-Law 2010-1 in the City of Greater Sudbury to implement the recommended changes in accordance with the report from the General Manager of Infrastructure Services dated March 4, 2014.

Background

Michael Street, Rayside Balfour

The Ward 3 Councillor has forwarded requests from area residents to prohibit parking on both sides of Michael Street. Vehicles from the abutting commercial properties are parking on both sides of the street which restricts access for through traffic.

Michael Street is located south of Highway 144 in the community of Chelmsford (see Exhibit "A"). Michael Street is a local residential road that is only about 100 metres long and is constructed to a rural standard with narrow gravel shoulders. It serves as access to the abutting commercial development and a residential subdivision to the south.

Staff supports prohibiting parking on both sides of Michael Street from Highway 144 to Monique Street. The Ward 3 Councillor has also indicated his support for the recommendation.

Signed By

Report Prepared By

Dave Kivi
Co-ordinator of Transportation & Traffic
Engineering Services
Digitally Signed Mar 5, 14

Division Review

David Shelsted
Director of Roads & Transportation
Services
Digitally Signed Mar 5, 14

Recommended by the Department

Tony Cecutti
General Manager of Infrastructure
Services
Digitally Signed Mar 5, 14

Recommended by the C.A.O.

Doug Nadorozny
Chief Administrative Officer
Digitally Signed Mar 5, 14

South Bay Road, Sudbury

The City's Roads and Transportation Services Division has received requests from area residents to extend the existing parking restrictions on South Bay Road further east to improve safety.

South Bay Road is a collector roadway located in Sudbury and provides a connection between Ramsey Lake Road and the Lake Laurentian Conservation Area (see Exhibit "B"). It is constructed to a rural standard with an asphalt surface width of 7.8 metres. It has paved shoulders from Ramsey Lake Road to Athletic Building Road and gravel shoulders from Athletic Building Road to the east end.

Currently, parking is prohibited on both sides of the roadway from Ramsey Lake Road to 300 metres east of Athletic Building Road. Parking was originally prohibited on South Bay Road to prevent students who attend classes at Laurentian University from parking on the roadway. With the addition of the Northern Ontario School of Medicine, parking restrictions were extended to the current limits in 2011. However, students have started parking beyond the prohibited area.

To improve safety, staff recommends that the parking restrictions on the south side of South Bay Road be extended by 50 metres to improve sight lines near a vertical crest curve. It is also recommended that parking on the north side of South Bay Road be extended to Arlington Boulevard. The Ward 10 Councillor has indicated her support for the recommendation.

EXHIBIT A

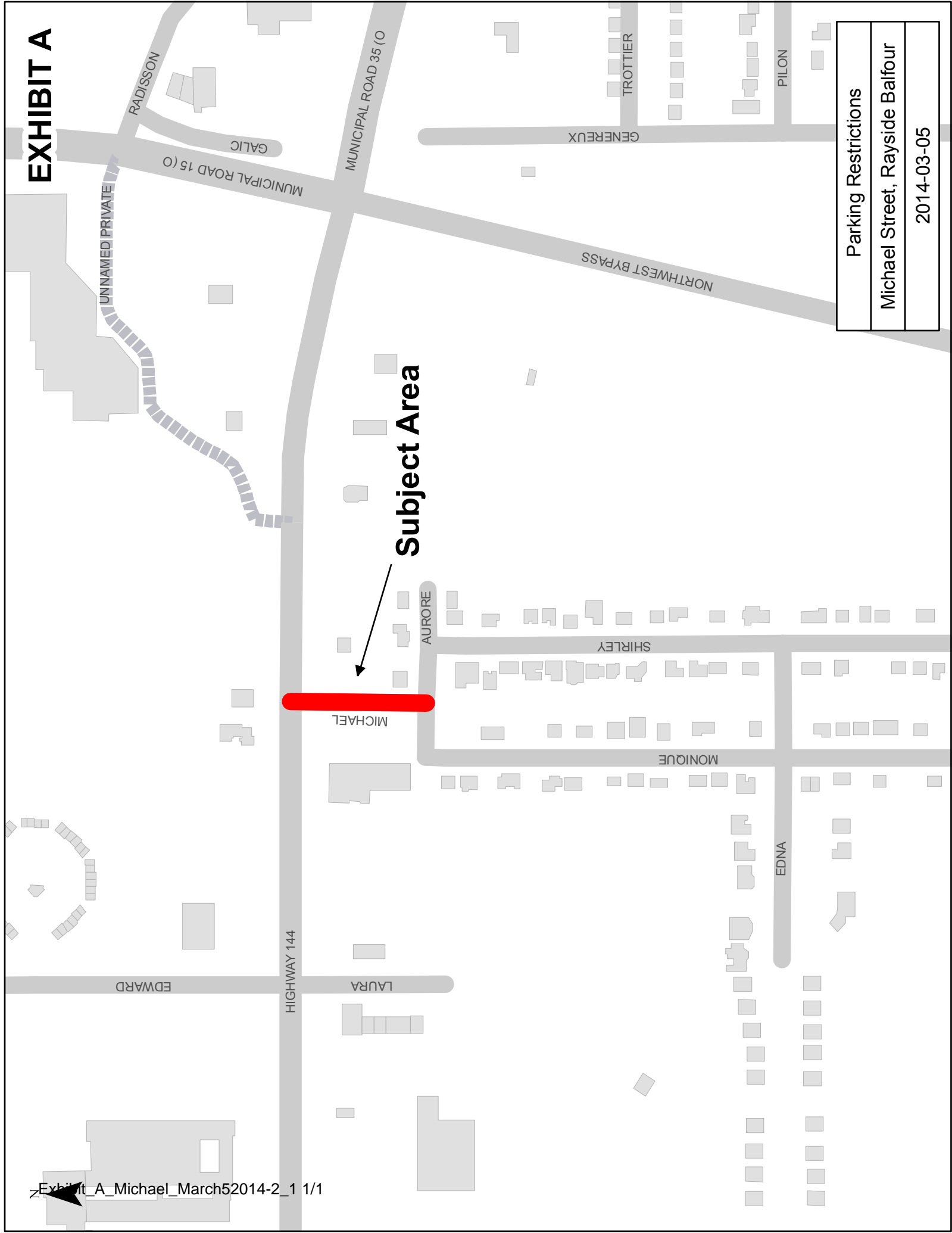

Parking Restrictions
Michael Street, Rayside Balfour
2014-03-05

EXHIBIT B

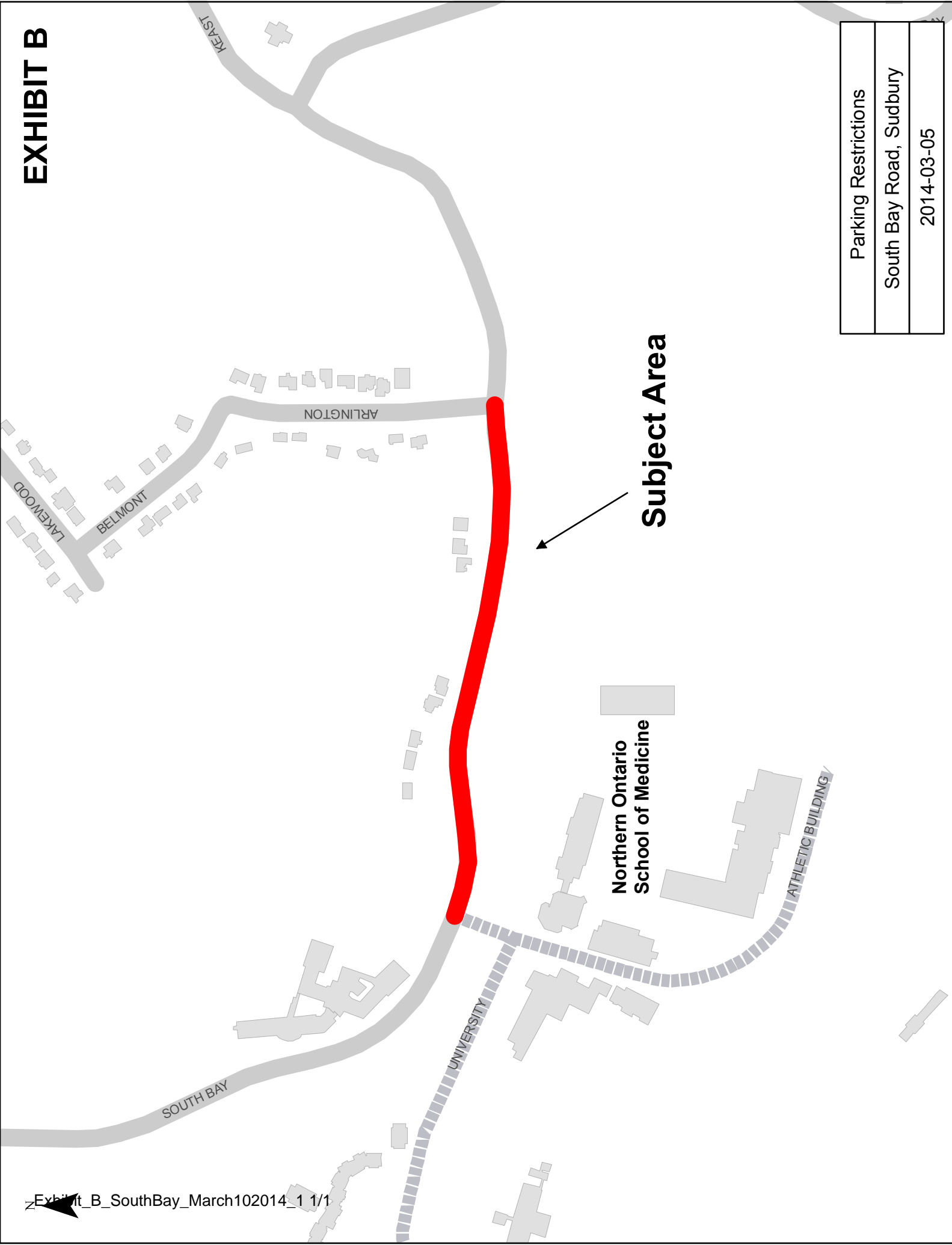

Parking Restrictions
South Bay Road, Sudbury
2014-03-05