

CORSI HILL PLAYSCAPE

Innovative Sustainable
Play Spaces

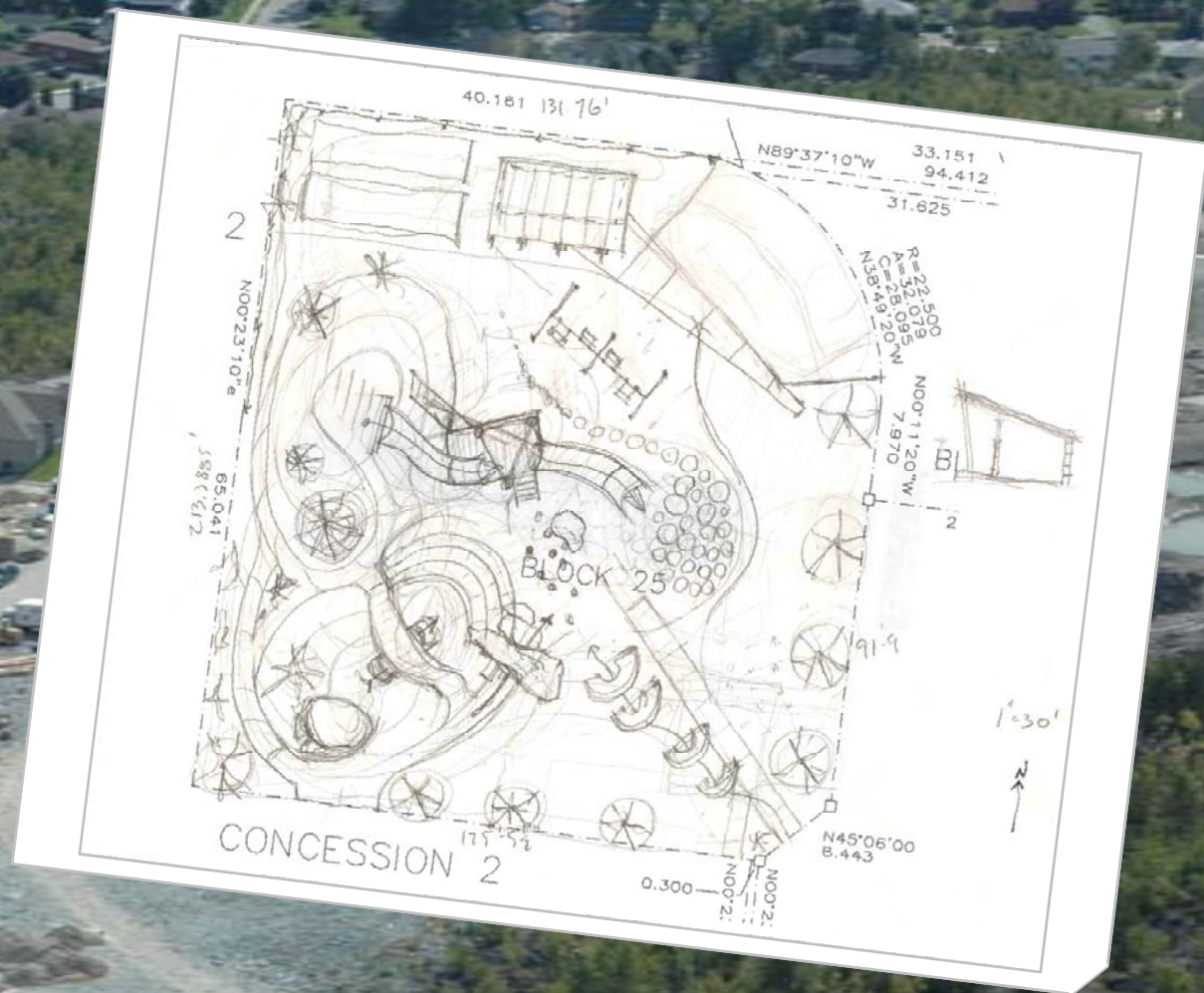

CASTELLAN JAMES + PARTNERS
ARCHITECTS INC



'Play – What children and young people do when they follow their own ideas and interests, in their own way and for their own reasons.' – Getting Serious About Fun

'The Provision of Play – A space, some facilities or equipment or a set of activities intended to give children the opportunity to play as defined above. At its most successful, it offers children and young people as much choice, control and freedom as possible within reasonable boundaries.' – Getting Serious About Fun

"Playscape" a space created as natural as possible, with as little man made components as possible. Using native plants, rolling hills, lots of trees. Playscapes offer a wide range of open-ended play options that allow children to be creative and use their imagination. Playscapes offer a wide range of developmental benefits to children, rehabilitation programs and all people in general.' – Wikipedia





'The need to play is fundamental to how young people develop their emotional, physical, & intellectual potential. Play encourages children to explore, practise, build-up skills, take risks, make mistakes & learn how to think imaginatively & creatively. Children gain a real sense of achievement through play & learn how to co-operate with other children. Play is a way for children to discover the world around them & explore new means of expressing their ideas.'

Baroness Ashton & Ivan Lewis, Department For Education & Skills





‘The idea is to find simple solutions that don’t specify the type of play.’

Tim Nash, Project Manager Murase Associates





Garden of Senses,
Natural Playground Designer, Helle Nebelong, Denmark



Kiwanis Park,
Back to reality, playscapes



‘Playing on traditional structures becomes simplified, and then the child doesn’t have to pay attention to his or her movements.’

Helle Nebelong, Danish Landscape Architect



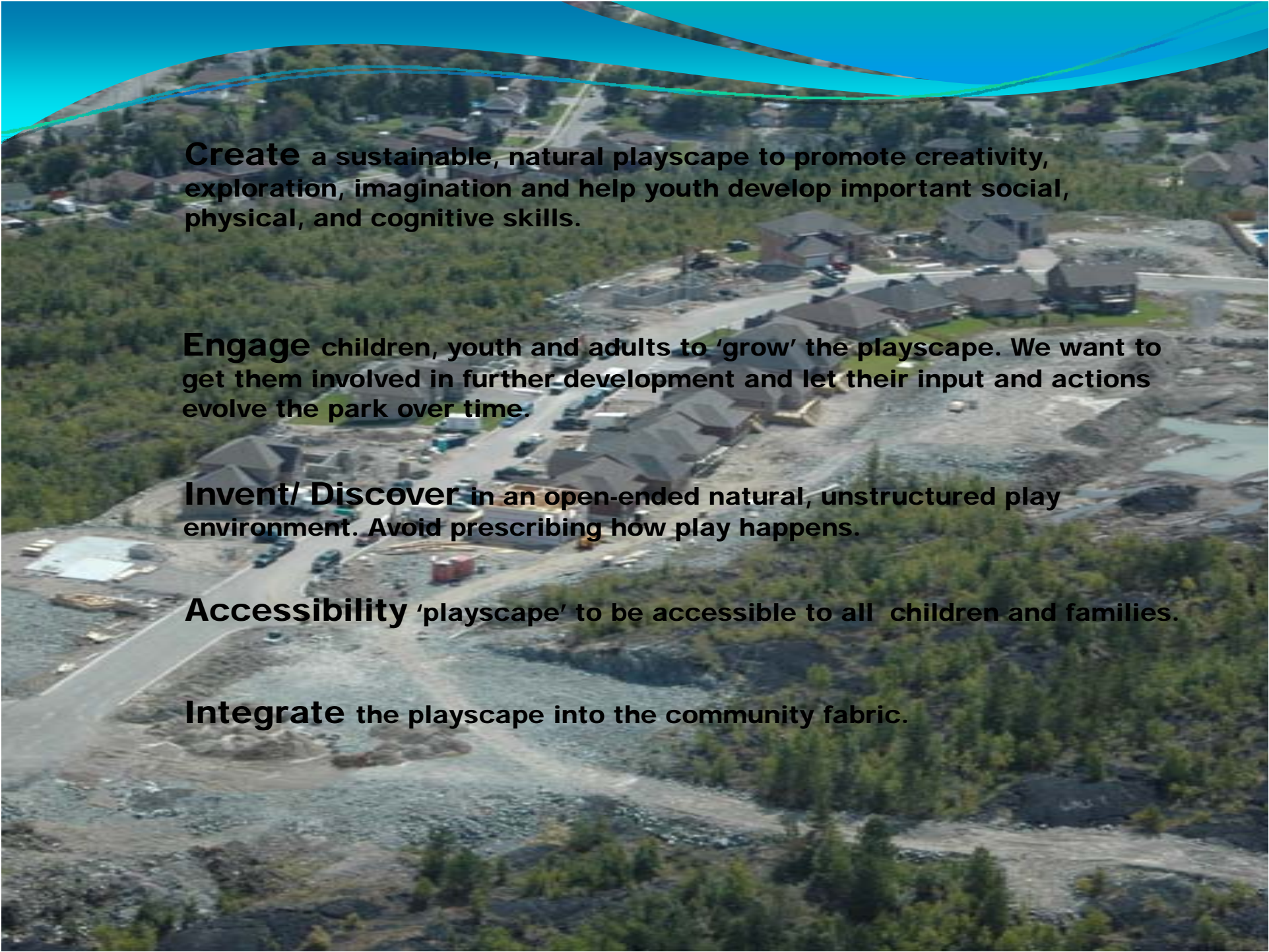

Create a sustainable, natural playscape to promote creativity, exploration, imagination and help youth develop important social, physical, and cognitive skills.

Engage children, youth and adults to 'grow' the playscape. We want to get them involved in further development and let their input and actions evolve the park over time.

Invent/ Discover in an open-ended natural, unstructured play environment. Avoid prescribing how play happens.

Accessibility 'playscape' to be accessible to all children and families.

Integrate the playscape into the community fabric.







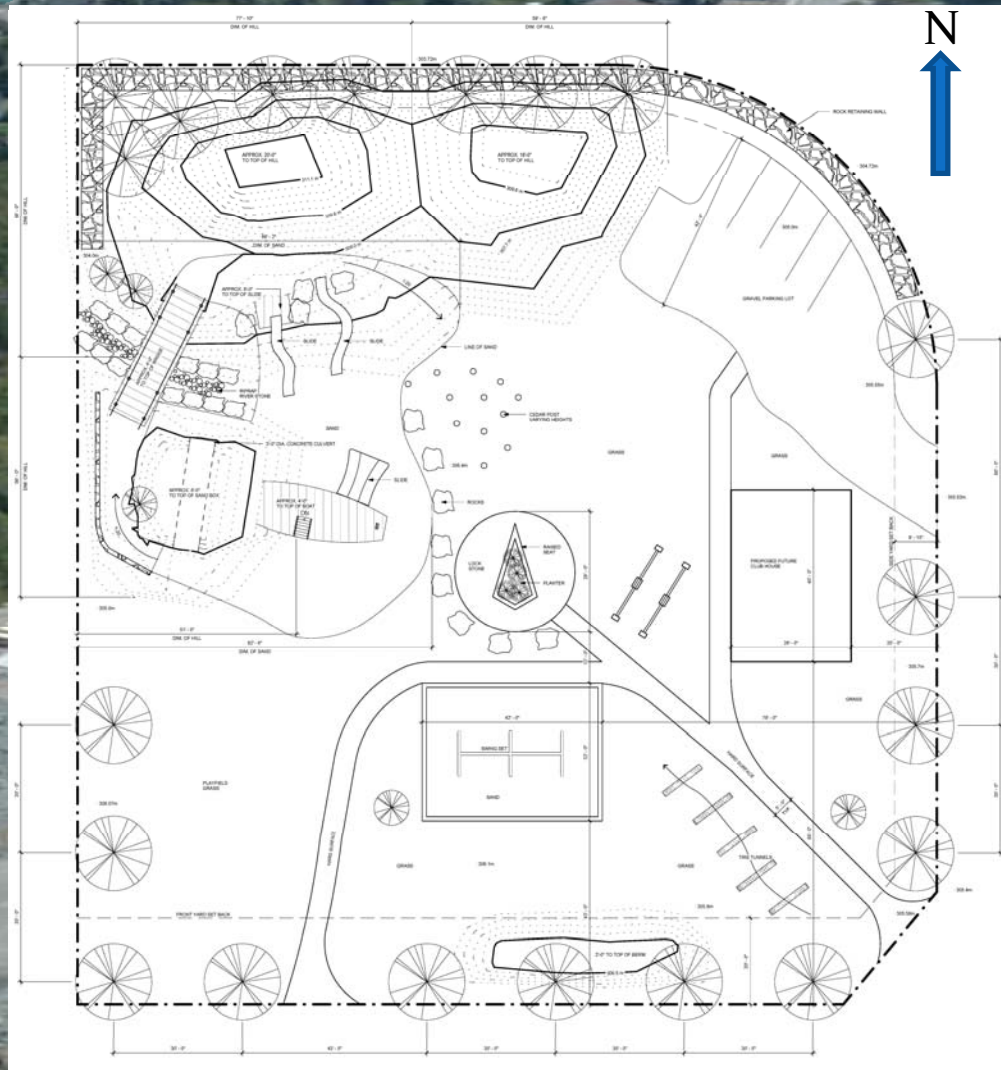

CORSI HILL PARK DEVELOPMENT

Issue Date: 11-10-07
 CASTELLAN JAMES + PARTNERS
 ARCHITECTS INC.

SITE PLAN

A-1





Murergarden Playground,
Natural Playground Designer, Helle Nebelong, Denmark



Learning Community Playground, Rhode Island,
Laurencia Strauss



Monstrum Playgrounds,
Back to reality, playscapes



Parque Gulliver



Parque Gulliver, Valencia Spain,
Back to reality, playscapes



Grosse Tête, Francois Lalanne, La Grande Borne,
Grigny France



Future Developments:

Club House

- A place to be, winter, summer, rain or shine.
- An accessible gathering place for birthdays, weddings, social events and just every day play.
- Take advantage of 'west' light with larger windows, warm and inviting.

Technology:

- Incorporate as many "green" technologies as possible and relevant.
- Solar lighting, both the site and building. Attempt to keep off the grid.
- Mechanical type installations that foster experimentation with various natural elements.

Community

- Integrate the park into the urban condition. There is a real opportunity to link this park into the trail system via Martindale road.

