

Schedule 'B'

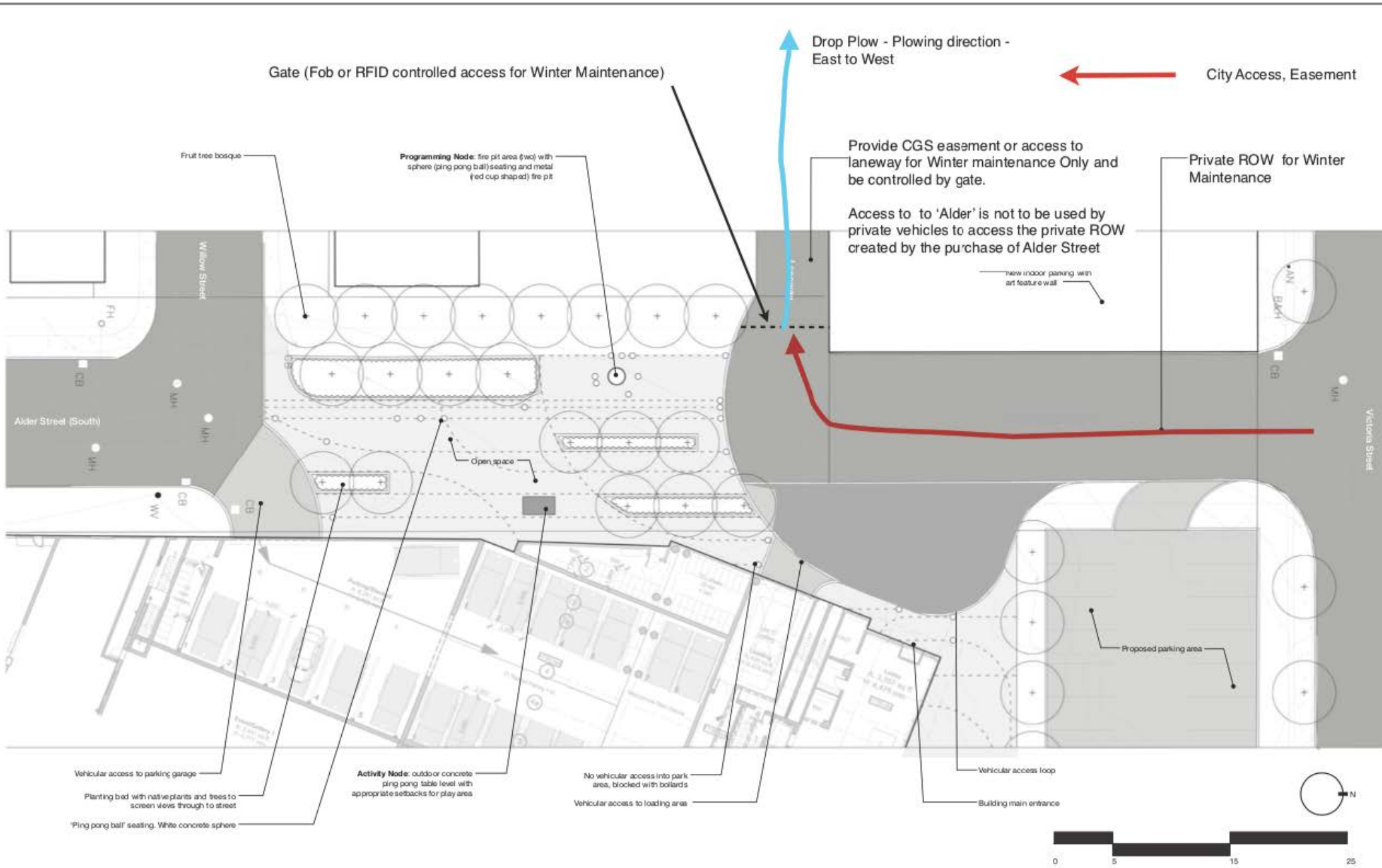

The park is playful both in its concept and programme. The concept is derived from the former unique industrial use of the building - a brewery. For many, the experiences had with beer are ones filled with enjoyment; experimenting with taste, toxicity and troublemaking. At different stages of life, beer is consumed differently, though, always rooted in fun. Alder Park is designed with this in mind. The park focuses on lighter side of beer - an innocent time when consuming beer is celebrated along side red cups and ping pong balls.



Throughout the site, white spheres serve as seating and bollards, symbolizing ping pong balls. A unique and interesting feature, they are sure to inspire conversation at least. The white spheres are integral to the paving pattern. An alternating line of unit pavers leads from each sphere symbolizing the path of flight of a ping pong ball as they arc gently towards a red cup. What's more fitting than enjoying a beer around a fire on a cool summer evening? Fire pit areas will feature metal fire pits in the shape of a red cup. The fire pit will be surrounded by spheres for seating but has enough space to accommodate extra chairs for larger parties.

The Brewer Lofts - Landscape Design

The site will feature planting beds that follow the gentle curves in the paving pattern. The beds will feature resilient native plant material, ornamental grasses and full form specimen trees to provide shade in parts of the park.



Hippocrepis



Northern Sea Oats

At the centre of the vehicular entry loop, there will be a water feature incorporating the existing large brewing tank from the former brewery. The tank will be retrofitted so water gushes out the bottom into a holding reservoir with a metal grate covering it. In addition to holding water, the reservoir will be planted with resilient water plants which will peak through the grate creating the illusion that the water feature is built on a vegetated green mat.



Existing Brewery Tank



Proposed Fountain

Every park should include the opportunity for active physical enjoyment. As such, Alder Park will include two outdoor ping pong tables. Ping pong, or table tennis, is an accessible sport that has been included in the Olympics and Paralympics since 1988 and 1960, respectively. It's a fun and engaging sport which can be played by individuals from 8 to 80 years of age.



Outdoor Ping Pong Table (Riverdale Park East, Toronto)



Outdoor Ping Pong Table Detail

Considering the unique urban context of the park is important when designing the internal form system. Urban parks tend to be very connected to their surroundings. In this instance, two streets front the park, as well as a laneway and multiple buildings. Access to the main ingress and egress points must be easily accessible, but still, the circulation within the site should maintain an experience that is interesting and playful. Indirectly-direct routes take users from one end of the park to the other, and lead from the building to the laneway. Instead of being a straight path, routes are slightly biased, or include visual screening and may incorporate 'obstacles' such as seating, planting beds, or programmed areas to entice the user to slow down and enjoy the space.

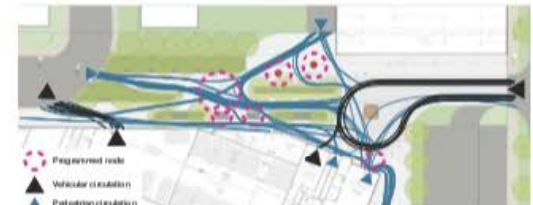

Main Paths of Circulation and Gathering Areas



INSPIRATION BOARD

