

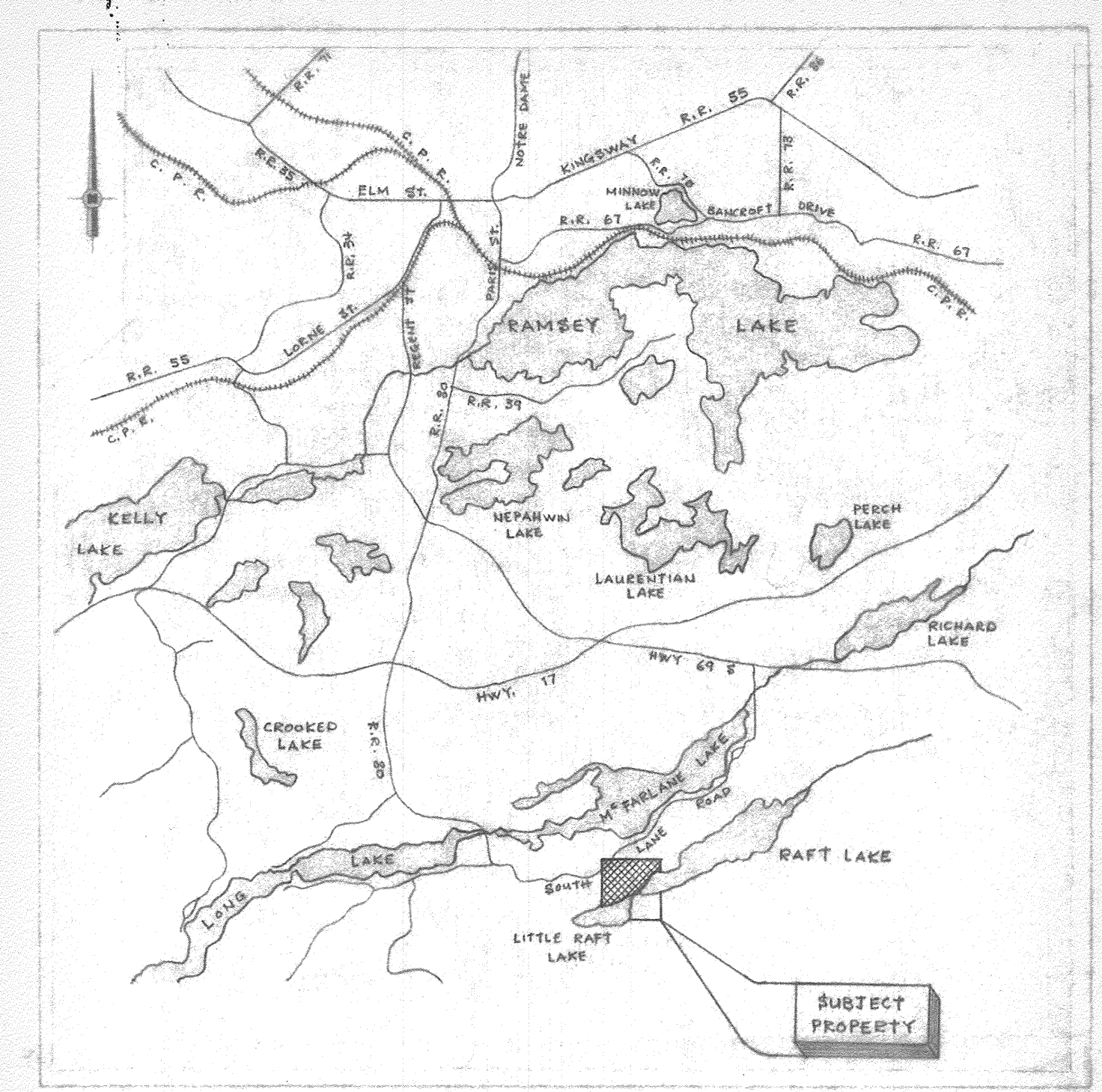

DRAFT PLAN

OF PROPOSED SUBDIVISION ON
PARCEL 9502 S.E.S.
PART OF LOT 2, CONCESSION 3
TOWNSHIP OF BRODER
CITY OF SUDBURY
REGIONAL MUNICIPALITY OF SUDBURY
DISTRICT OF SUDBURY

CONTOUR INTERVAL = 2 m



KEY PLAN

Subject to the conditions, if any set forth
in our letter dated March 14th, 1997
this draft plan is approved under section
51 of The Planning Act, R.S.O. 1990 this
14th day of March, 1997
D.P. La Thall
By-law # 83-140

RECEIVED
JUNO 7 1996
Planning and Development Department

ADDITIONAL INFORMATION

- AS REQUIRED BY SECTION 51 (17) OF THE 1994 PLANNING ACT
- a) AS SHOWN ON PLAN
 - b) AS SHOWN ON PLAN
 - c) AS SHOWN ON PLAN
 - d) LOW DENSITY RESIDENTIAL ESTATE LOTS AREA = 1.0 HECTARES MINIMUM. AREA = 2.0 HECTARES MINIMUM WHERE FRONTING ON EXISTING PUBLIC ROADS.
 - e) ESTABLISHED LOW DENSITY R-1 USES AND CROWN LAND TO THE NORTH, SOUTH WEST AND EAST. ESTABLISHED M-5 COMMERCIAL TO THE NORTH WEST.
 - f) AS SHOWN ON PLAN
 - g) AS SHOWN ON PLAN
 - h) PRIVATE WATER SUPPLY
 - i) SHALLOW TEST HOLES INDICATE THAT THERE IS AT LEAST A 450 mm TO 600 mm DEPTH OF SILTY SAND, TILL OVERLYING BEDROCK OR BOULDERS.
 - j) AS SHOWN ON PLAN
 - k) GARBAGE COLLECTION, FIRE PROTECTION, POLICE, ETC
 - l) AS SHOWN ON PLAN

OWNER'S CERTIFICATE

I HEREBY CONSENT TO THE MANNER IN WHICH THE LANDS SHOWN ON THIS PLAN ARE PROPOSED TO BE SUBDIVIDED AND REQUEST THE APPROVAL OF THE REGIONAL MUNICIPALITY OF SUDBURY.
DATE Feb 19/96 OWNER [Signature]

SURVEYOR'S CERTIFICATE

I HEREBY CERTIFY THAT THE BOUNDARIES OF THE LANDS TO BE SUBDIVIDED AND THEIR RELATIONSHIP TO THE ADJACENT LANDS ARE ACCURATELY AND CORRECTLY SHOWN ON THIS PLAN.
DATE February 15, 1996 ONTARIO LAND SURVEYOR [Signature]

DATE	REV. No.	DESCRIPTION	BY
JUNE 5, 1996	1	ROAD ALLOWANCES ADJUSTED	K.M.S.
RAFT LAKE SUBDIVISION			
SOUTH LAKE ROAD			
Scale: AS SHOWN	Approved By: JCN	Job No: 95200	Drawn By: K.M.S.
Date: JAN 1996			Revised:
DRAFT PLAN OF SUBDIVISION			
SPRIET ASSOCIATES ENGINEERS		SUDBURY LONDON	Drawing Number 1