



Composite Rendering #1

Option #1: Standard Pedestrian Bridge with ramps

Energy Court Pedestrian Bridge

Downtown Sudbury | November 15, 2017 | JLR No.: 27777-000.0



Rendering #1

Option #1: Standard Pedestrian Bridge with ramps

Energy Court Pedestrian Bridge

Downtown Sudbury | November 15, 2017 | JLR No.: 27777-000.0



Rendering #2

Option #1: Standard Pedestrian Bridge with ramps

Energy Court Pedestrian Bridge

Downtown Sudbury | November 15, 2017 | JLR No.: 27777-000.0



Rendering #4

Option #1: Standard Pedestrian Bridge with ramps

Energy Court Pedestrian Bridge

Downtown Sudbury | November 15, 2017 | JLR No.: 27777-000.0



Composite Rendering #1

Option #1A: Standard Pedestrian Bridge with elevators

Energy Court Pedestrian Bridge

Downtown Sudbury | November 15, 2017 | JLR No.: 27777-000.0

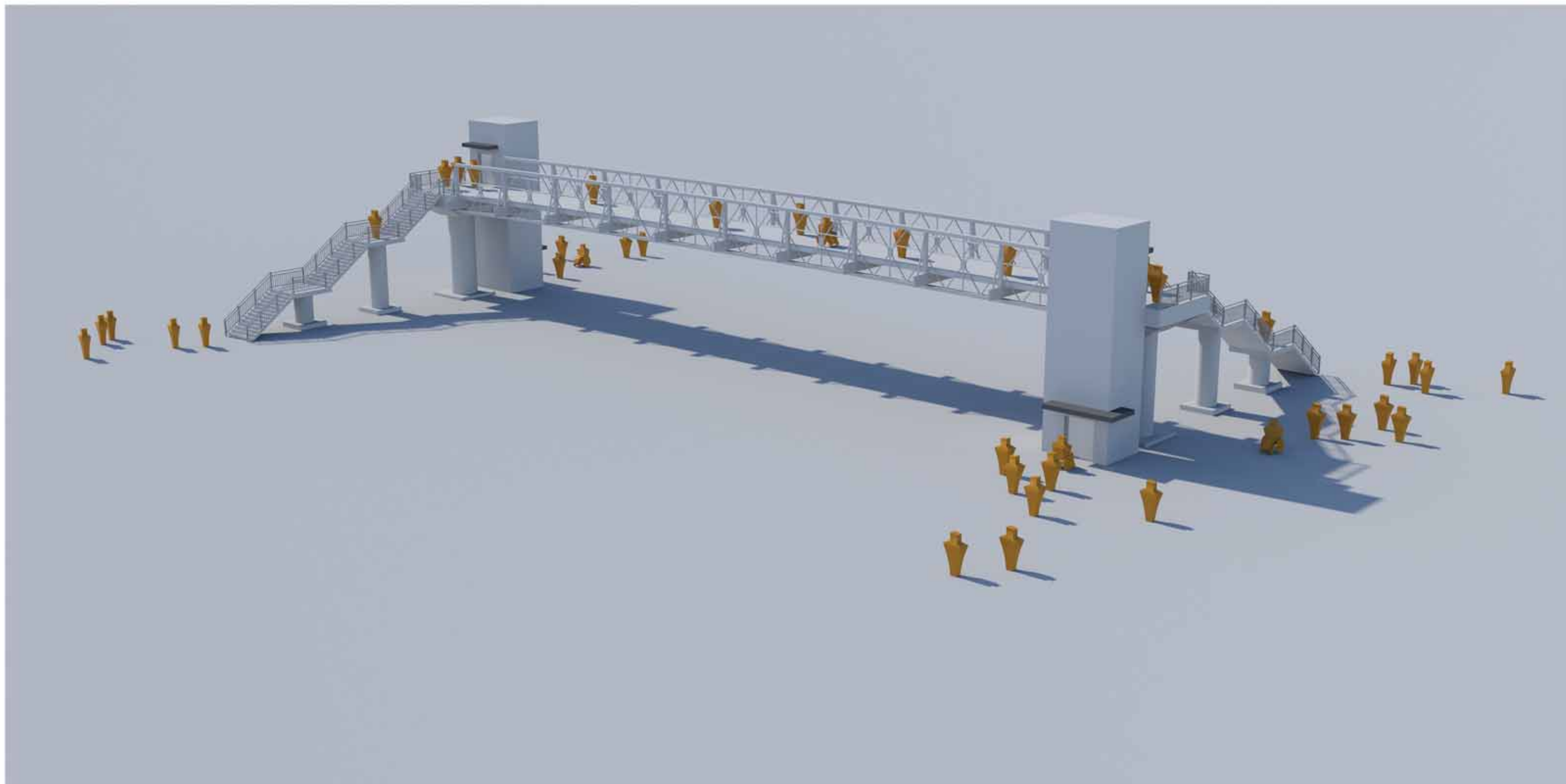

Rendering #1

Option #1A: Standard Pedestrian Bridge with elevators

Energy Court Pedestrian Bridge

Downtown Sudbury | November 15, 2017 | JLR No.: 27777-000.0

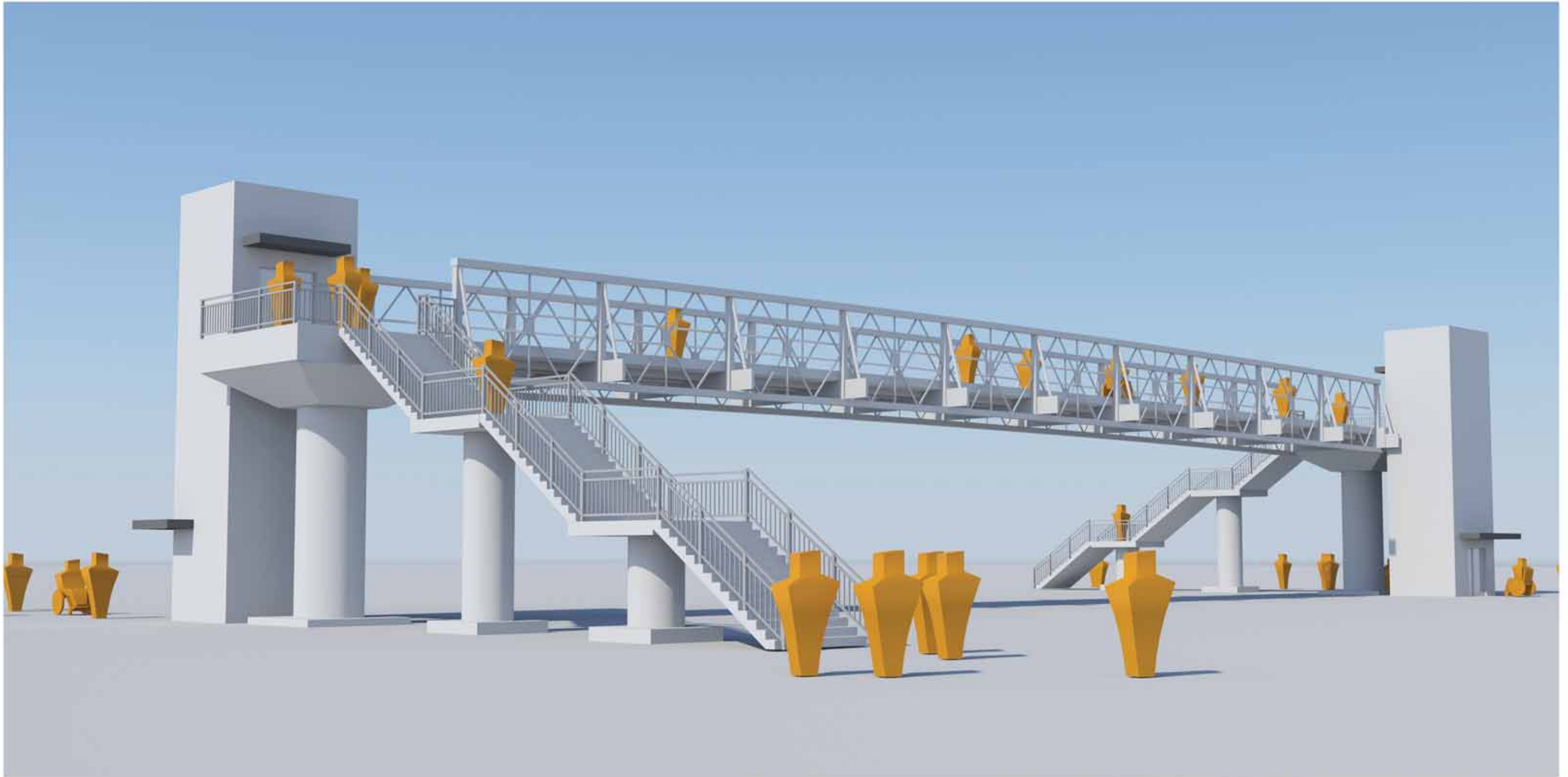

Rendering #2

Option #1A: Standard Pedestrian Bridge with elevators

Energy Court Pedestrian Bridge

Downtown Sudbury | November 15, 2017 | JLR No.: 27777-000.0



Conceptual Renderings

Option #2: Covered Pedestrian Bridge

Energy Court Pedestrian Bridge

Downtown Sudbury | November 15, 2017 | JLR No.: 27777-000.0



Conceptual Renderings

Option #3: Covered Pedestrian Bridge with Architectural Details and Green Spaces on Ramps

Energy Court Pedestrian Bridge

Downtown Sudbury | November 15, 2017 | JLR No.: 27777-000.0